



RCI Engineering LLC
208 River Knoll Drive
Mayville, WI 53050

P: 920-387-9804
P: 888-472-4552
F: 920-387-9806

www.RCI.ag

Marketing Bulletin info@RCI.ag
F-Series Bumper / Storage Box / Water Tank System
For use with the F8 and F9 SPFH



Base Bumper

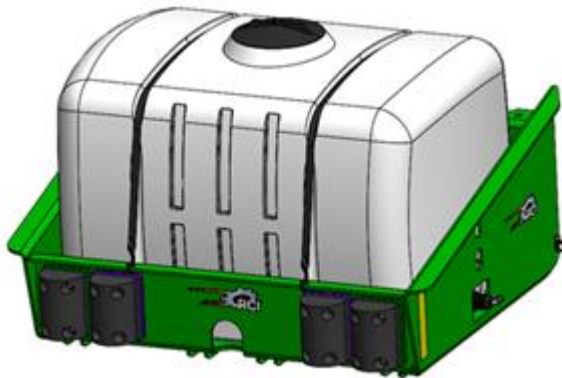

Water Tank

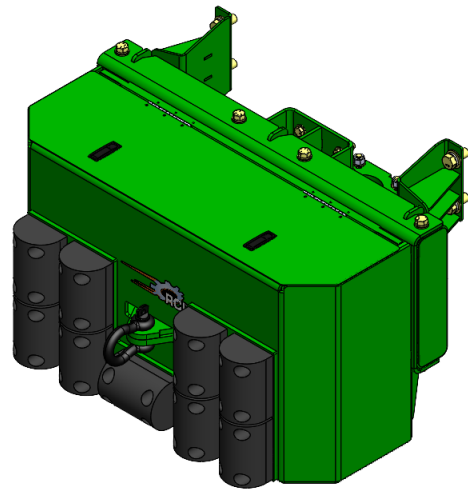

Storage Box



Bolt-On Pintle Hitch, Receiver Hitch and Tow Pin



RCI Engineering LLC
 208 River Knoll Drive
 Mayville, WI 53050

P: 920-387-9804
 P: 888-472-4552
 F: 920-387-9806
 www.RCI.ag

Marketing Bulletin info@RCI.ag

The F-Series Bumper Attachment and Accessories are available from RCI Engineering for the John Deere F8- and F9-Series Self-Propelled Forage Harvesters.

Intended Use:

To protect the back of the SPFH from damage incurred by tractors and trucks following the SPFH when opening fields. The system also provides for additional water, a storage box, and bolt-on accessories for use in special applications.

Features:

1. Double the rubber bumper pads from previous models.
2. Includes shackle to attach tow strap or chain to hitch.
3. Ears for lifting and chain/strap retention when not in use.
4. Adjustable pad position to adjust for proper ground clearance as needed.
5. Compatible with Deere integrated weight system.
6. Reinforced mounting holes for accessories.
7. 200-gallon water tank option.
8. Standalone storage box option with reinforced supports for rubber pads.

Specifications – Base Weight:

RC125118	Bundle, F8- and F9-Series Base Bumper	694 lbs
RC125200	Bundle, F8- and F9-Series Storage Box Bumper	962 lbs
RC125186	Bundle, Water Tank (w/ base, water)	Approx. 2,750 lbs (1250 kg)

Ordering Information:

RC125118	Bundle, F8 & F9 SPFH Base Bumper	Must order if water tank used
RC125200	Bundle, F8 & F9 Storage Box Bumper	Order as stand-alone – does not need RC125118
RC125186	Assembly, F8 & F9 Water Tank Bumper	Also order RC125118
RC125178	Kit, Pin and Bracket	Compatible with RC125118
RC125068	Hitch, Pintle	Compatible with RC125118
RC950663	Kit, 2" Bolt-On Receiver Tube	Compatible with RC125118

*All times are dependent on the use of appropriate tools and technician experience. No modifications to the SPFH are required for the installation, only the removal of a few components at the rear mount plate.

Estimated Installation Times:

Base Bundle Installation	1.5 hours
Water Tank Initial Installation	1 hour
Field change between Tank and bumper	0.5 hour

RCI Engineering LLC is a John Deere Allied Supplier. Products and spare parts are available through your John Deere Dealer, who orders directly from RCI. All parts, service, and warranty matters are handled by RCI, with a 1-year parts and labor warranty. Visit www.RCI.ag for more information.